

CSB Corporation Stop



Primary Fluid Systems is proud to introduce its new product line: the **CSB Corporation Stop**.

It is certified to **NSF/ANSI-61**, and designed to inject chemical into the center stream of the flow.

Features

- Brass body construction, meeting or exceeding the Lead Free (LF) Requirements of <0.25%
- Available with PVC, CPVC, Stainless Steel or PVDF injection quills and couplings
- Available in NPT or AWWA Pipe Connections in 3/4" or 1" sizes
- 1/2" NPT chemical connection sizes standard
- Adjustable Insertion Length from 0 to 7.5" (19cm)
- Stainless Steel Retainer cable for safe removal of quill from service
- Maximum Pressure to 150 PSIG (10 bar) at 68°F (20°C)

Benefits

- Injection of chemicals into the center of a process pipeline provides a more homogeneous mixture
- Easy removal of the injection quill without disrupting the use of the process pipe main
- Can be used in conjunction with a 'Hot Tap' for easy installation



Size Chart

Model #	Quill Tube Size / Material	Quill Chemical Connection Size	Process Connection Size / Material	Gland Seal
CSB-75NPT-PVC	3/8" = 10mm PVC	1/2" NPT PVC	3/4" NPT Brass	NSF61 EPDM
CSB-75AWWA-PVC	3/8" = 10mm PVC	1/2" NPT PVC	3/4" AWWA Brass	NSF61 EPDM
CSB-100NPT-PVC	1/2" = 15mm PVC	1/2" NPT PVC	1" NPT Brass	NSF61 EPDM
CSB-100AWWA-PVC	1/2" = 15mm PVC	1/2" NPT PVC	1" AWWA Brass	NSF61 EPDM
CSB-75NPT-CPVC	3/8" = 10mm CPVC	1/2" NPT CPVC	3/4" NPT Brass	NSF61 EPDM
CSB-75AWWA-CPVC	3/8" = 10mm CPVC	1/2" NPT CPVC	3/4" AWWA Brass	NSF61 EPDM
CSB-100NPT-CPVC	1/2" = 15mm CPVC	1/2" NPT CPVC	1" NPT Brass	NSF61 EPDM
CSB-100AWWA-CPVC	1/2" = 15mm CPVC	1/2" NPT CPVC	1" AWWA Brass	NSF61 EPDM
CSB-75NPT-S/S	3/8" = 10mm S/S	1/2" NPT S/S	3/4" NPT Brass	NSF61 EPDM
CSB-75AWWA-S/S	3/8" = 10mm S/S	1/2" NPT S/S	3/4" AWWA Brass	NSF61 EPDM
CSB-100NPT-S/S	1/2" = 15mm S/S	1/2" NPT S/S	1" NPT Brass	NSF61 EPDM
CSB-100AWWA-S/S	1/2" = 15mm S/S	1/2" NPT S/S	1" AWWA Brass	NSF61 EPDM
CSB-75NPT-PVDF	3/8" = 10mm PVDF	1/2" NPT PVDF	3/4" NPT Brass	NSF61 EPDM
CSB-75AWWA-PVDF	3/8" = 10mm PVDF	1/2" NPT PVDF	3/4" AWWA Brass	NSF61 EPDM
CSB-100NPT-PVDF	1/2" = 15mm PVDF	1/2" NPT PVDF	1" NPT Brass	NSF61 EPDM
CSB-100AWWA-PVDF	1/2" = 15mm PVDF	1/2" NPT PVDF	1" AWWA Brass	NSF61 EPDM

3/4" Size Parts List

ITEM	PART NUMBER	DESCRIPTION	MATERIAL	QTY
1	CSB-75-1-ADAPTER-NPT	3/4" NPT	LEAD FREE BRASS	1
	OPTION: CSB-75-1-ADAPTER-AWWA	3/4" AWWA	LEAD FREE BRASS	
2	CSB-75-2-VALVE	3/4" BALL VALVE	LEAD FREE BRASS	1
3	CSB-75-3-ADAPTER	3/4" NPT	LEAD FREE BRASS	1
4	CSB-75-4-SEAL	GLAND SEAL	NSF61 EPDM	1
5	CSB-75-5-WASHER	WASHER	ACETAL	1
6	CSB-75-6-NUT	3/4" COUPLING NUT	LEAD FREE BRASS	1
7	CSB-75-7-PIPE-PVC	3/8" SCH80 PIPE	PVC	1
	OPTION: CSB-75-7-PIPE-PVC-AWWA	3/8" SCH80 PIPE	PVC	
	OPTION: CSB-75-7-PIPE-CPVC	3/8" SCH80 PIPE	CPVC	
	OPTION: CSB-75-7-PIPE-CPVC-AWWA	3/8" SCH80 PIPE	CPVC	
8	CSB-75-8-COUPLING-PVC	3/8" TO 1/2" COUPLING	PVC	1
	OPTION: CSB-75-8-COUPLING-CPVC	3/8" TO 1/2" COUPLING	CPVC	
9	CSB-75-9-RETAINER	SAFETY RETAINER	PVC/STEEL	1
10	CSB-175-10-SCREW	1/4" x 3/4" HEX BOLT	18.8 STAINLESS STEEL	1

1" Size Parts List

ITEM	PART NUMBER	DESCRIPTION	MATERIAL	QTY
1	CSB-100-1-ADAPTER-NPT	1" NPT	LEAD FREE BRASS	1
	OPTION: CSB-100-1-ADAPTER-AWWA	1" AWWA	LEAD FREE BRASS	
2	CSB-100-2-VALVE	1" BALL VALVE	LEAD FREE BRASS	1
3	CSB-100-3-ADAPTER	1" NPT	LEAD FREE BRASS	1
4	CSB-100-4-SEAL	GLAND SEAL	NSF61 EPDM	1
5	CSB-100-5-WASHER	WASHER	ACETAL	1
6	CSB-100-6-NUT	1" COUPLING NUT	LEAD FREE BRASS	1
7	CSB-100-7-PIPE-PVC	1/2" SCH80 PIPE	PVC	1
	OPTION: CSB-100-7-PIPE-PVC-AWWA	1/2" SCH80 PIPE	PVC	
	OPTION: CSB-100-7-PIPE-CPVC	1/2" SCH80 PIPE	CPVC	
	OPTION: CSB-100-7-PIPE-CPVC-AWWA	1/2" SCH80 PIPE	CPVC	
8	CSB-100-8-COUPLING-PVC	1/2" COUPLING	PVC	1
	OPTION: CSB-100-8-COUPLING-CPVC	1/2" COUPLING	CPVC	
9	CSB-100-9-RETAINER	SAFETY RETAINER	PVC/STEEL	1
10	CSB-175-10-SCREW	1/4" x 3/4" HEX BOLT	18.8 STAINLESS STEEL	1

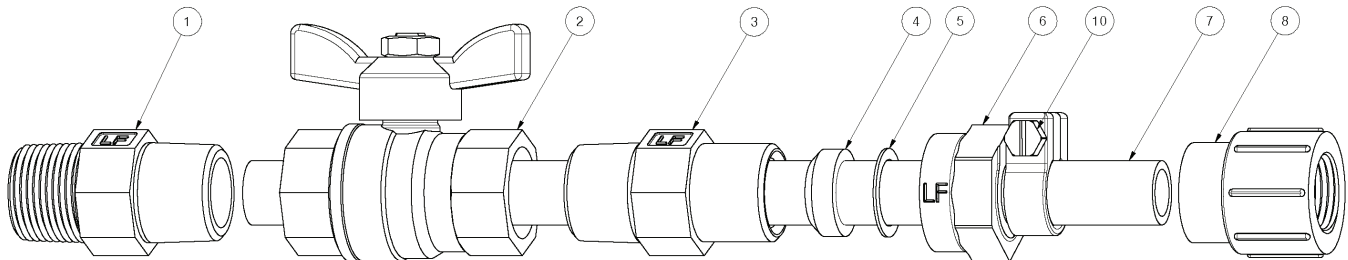

For more information, please visit

www.primaryfluid.com

Primary Fluid Systems Inc.
1050 Cooke Boulevard
Burlington, ON, Canada
1-800-776-6580